

# Manipulační tyče, provedení C

## Popis zboží/obrázky produktu



### Popis

#### Materiál:

Knoflíky duroplast PF 31.

Tyč ocel 1.0718 nebo nerez 1.4305.

#### Provedení:

Duroplast černý, vyleštěno do vysokého lesku.

Ocel brynýrovaná nebo nerezová ocel lesklá.

## Výkresy

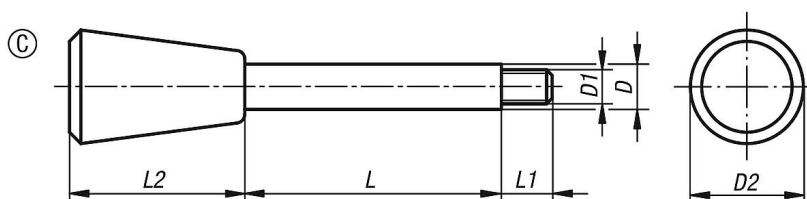

## Přehled zboží

| Objednací číslo | Materiál základní těleso | Provedení | D  | D1  | D2 | L   | L1 | L2 |
|-----------------|--------------------------|-----------|----|-----|----|-----|----|----|
| K0179.408X35    | ocel                     | C         | 8  | M6  | 20 | 35  | 9  | 31 |
| K0179.408X50    | ocel                     | C         | 8  | M6  | 20 | 50  | 9  | 31 |
| K0179.408X65    | ocel                     | C         | 8  | M6  | 20 | 65  | 9  | 31 |
| K0179.410X50    | ocel                     | C         | 10 | M8  | 25 | 50  | 13 | 38 |
| K0179.410X65    | ocel                     | C         | 10 | M8  | 25 | 65  | 13 | 38 |
| K0179.410X80    | ocel                     | C         | 10 | M8  | 25 | 80  | 13 | 38 |
| K0179.410X100   | ocel                     | C         | 10 | M8  | 25 | 100 | 13 | 38 |
| K0179.412X65    | ocel                     | C         | 12 | M10 | 30 | 65  | 15 | 46 |
| K0179.412X80    | ocel                     | C         | 12 | M10 | 30 | 80  | 15 | 46 |
| K0179.412X100   | ocel                     | C         | 12 | M10 | 30 | 100 | 15 | 46 |
| K0179.412X125   | ocel                     | C         | 12 | M10 | 30 | 125 | 15 | 46 |
| K0179.414X80    | ocel                     | C         | 14 | M12 | 35 | 80  | 16 | 53 |
| K0179.414X100   | ocel                     | C         | 14 | M12 | 35 | 100 | 16 | 53 |
| K0179.414X125   | ocel                     | C         | 14 | M12 | 35 | 125 | 16 | 53 |
| K0179.414X160   | ocel                     | C         | 14 | M12 | 35 | 160 | 16 | 53 |
| K0179.1408X35   | nerezová ocel            | C         | 8  | M6  | 20 | 35  | 9  | 31 |
| K0179.1408X50   | nerezová ocel            | C         | 8  | M6  | 20 | 50  | 9  | 31 |
| K0179.1408X65   | nerezová ocel            | C         | 8  | M6  | 20 | 65  | 9  | 31 |
| K0179.1410X50   | nerezová ocel            | C         | 10 | M8  | 25 | 50  | 13 | 38 |
| K0179.1410X65   | nerezová ocel            | C         | 10 | M8  | 25 | 65  | 13 | 38 |
| K0179.1410X80   | nerezová ocel            | C         | 10 | M8  | 25 | 80  | 13 | 38 |
| K0179.1410X100  | nerezová ocel            | C         | 10 | M8  | 25 | 100 | 13 | 38 |
| K0179.1412X65   | nerezová ocel            | C         | 12 | M10 | 30 | 65  | 15 | 46 |
| K0179.1412X80   | nerezová ocel            | C         | 12 | M10 | 30 | 80  | 15 | 46 |
| K0179.1412X100  | nerezová ocel            | C         | 12 | M10 | 30 | 100 | 15 | 46 |
| K0179.1412X125  | nerezová ocel            | C         | 12 | M10 | 30 | 125 | 15 | 46 |
| K0179.1414X80   | nerezová ocel            | C         | 14 | M12 | 35 | 80  | 16 | 53 |
| K0179.1414X100  | nerezová ocel            | C         | 14 | M12 | 35 | 100 | 16 | 53 |
| K0179.1414X125  | nerezová ocel            | C         | 14 | M12 | 35 | 125 | 16 | 53 |
| K0179.1414X160  | nerezová ocel            | C         | 14 | M12 | 35 | 160 | 16 | 53 |

